

Fourth Floor

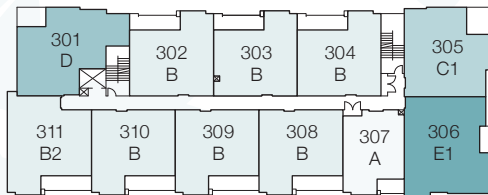

Third Floor

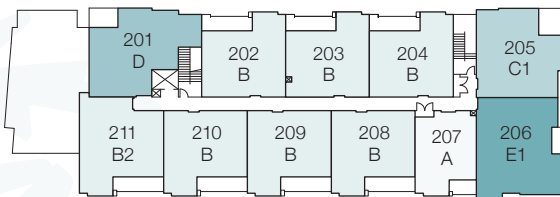

Second Floor

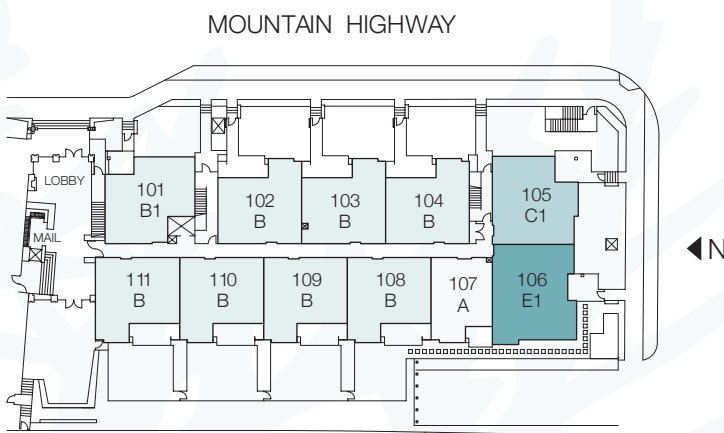

Ground Floor

- Avanti** | Plan A
 One bedroom
 638 – 655 sq.ft. (approx.)
- Brodie** | Plan B, B1, B2
 Two bedroom
 836 – 962 sq.ft. (approx.)
- Cove** | Plan C1
 Two bedroom
 938 – 951 sq.ft. (approx.)
- Dawes** | Plan D
 Three bedroom
 999 – 1,009 sq.ft. (approx.)
- Ellsworth** | Plan E1
 Three bedroom
 1,087 – 1,102 sq.ft. (approx.)